

Technical Description and Instruction Manual

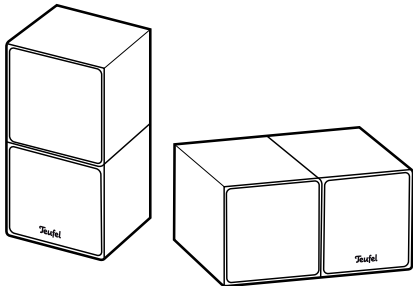

**Speaker Set
Cubycon 2**

Teufel

General Notes and Information

Proper use

Only use the speaker as described in this instruction manual. Any other use will be deemed as not in accordance with the instructions and may lead to damage of property or even persons. The manufacturer cannot be held liable for damages caused by improper use. The speaker is only intended for private use.



Before operating the speaker, please read the safety notes and instruction manual carefully. Only in this way, can you ensure that all functions are used in a safe and reliable manner. Store the instruction manual in a safe place and also be sure to pass it on to any subsequent owner.

Notice

The information in this document may change without prior notice and in no way constitutes any liability on the part of Lautsprecher Teufel GmbH. No part of this instruction manual may be reproduced in any form or be broadcast in any way electronically, mechanically, by photocopy or recording without the written permission of Lautsprecher Teufel GmbH.

Original packaging

If you wish to exercise your eight-week right of return, we ask that you be absolutely sure to hold onto the packaging. We can only accept the return of the device with the ORIGINAL PACKAGING. Empty boxes are not available!

Complaints

In case of a complaint we will need your invoice number and the serial or lot number for processing. The serial number is located on the back side of the device.

Thank you for your support!

Contact

Please contact our customer service with any questions, suggestions or comments:

Lautsprecher Teufel GmbH
BIKINI Berlin
Budapester Str. 44
10787 Berlin (Germany)

Phone 00800 - 200 300 40 (toll-free)

Fax +49 (0)30 / 300 930 930

E-mail: service@teufelaudio.com

www.teufelaudio.com

For Your Safety

Signal terms

You can find the following signal terms in these instructions:

WARNING

This signal term indicates a moderate risk, which, if not avoided, may result in death or severe injury.

CAUTION

This signal term indicates a low risk, which, if not avoided, may result in minor or moderate injury.

NOTICE

This signal term warns you of potential damage.

Safety notes

This chapter provides general safety information that should be considered for your own protection and that of others. Please note that additional warnings are listed in the individual chapters as necessary.

An unsuitable setup location may result in injury and damage.

- *If the speakers are not securely mounted, do not use them in vehicles, unstable locations, with insufficient brackets, on wobbly stands or furniture, etc. The speakers could tip over or fall and cause injury to persons or be damaged itself.*
- *Place the speakers in such a way that they cannot be knocked over inadvertently and make sure that the cables do not pose a trip hazard.*
- *If you want to use underframes or speaker stands, only use those recommended by the manufacturer.*
- *Do not place the speakers near heat sources (e.g. heaters, ovens, or other heat generating equipment such as amplifiers etc.).*
- *Do not use the speakers in environments where there is a risk of explosion.*
- *When storing the speakers, also ensure that it stands safely and that it cannot be knocked down or over.*

Children can become trapped in the plastic wrapping when playing and suffocate.

- *Do not allow children to play with the device or the plastic wrapping. Danger of suffocation.*
- *Ensure that children do not remove small parts from the device or take them off of the device. They could swallow the parts and choke.*



Extended listening at high volumes may lead to hearing loss.

- *To avoid damage to health, avoid extended listening at high volumes.*
- *When the volume is set high, always keep a certain distance from the device and never place your ear directly on the speaker.*
- *If the amplifier is set to full volume, this may produce very high sound pressure. This may have psychological consequences and also cause physical injury. Children and pets are particularly at risk. Set your signal source device volume control to a low setting before turning on the power.*

Improper use may lead to damage or fire.

- *Do not place open fire sources such as burning candles or similar on the speakers.*
- *Ensure sufficient ventilation.*
- *Do not expose the speakers to direct sunlight.*
- *Only use the speakers in indoor areas.*
- *Do not use the speakers in wet rooms and protect them against dripping or splashing water. Make sure that no vases or other liquid-filled containers are located on or near the speakers in order to prevent liquid from penetrating the housing.*

- ① 4 x Satellite speakers CUB 2 FR 15
- ② 1 x Center speaker CUB 2 C 15
- ③ 6x Rubber damping mats

i Check that the delivery is complete and nothing is damaged. If you find damage, do not operate the device; instead contact our service department.

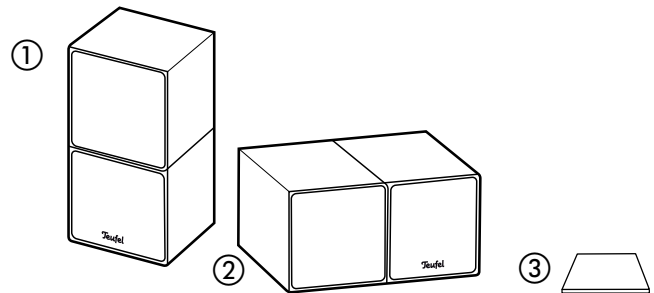

Setting up the Speakers

i Comprehensive instructions for correct installation can be found on our website at www.teufelaudio.com.

Specially designed speaker stands can be ordered from our webshop.

- Select a stable, level base or a suitable wall.
- Make sure that the environment is clean and free from dust.
- Select a location away from heat sources and direct sunlight.
- Do not place any heavy objects on the cord or the speaker.

Setup

The following data concern an “ideal home cinema”, in which the viewer or listener sits in a central position at a sufficient distance in front of the video screen or screen (see the following graphic) and no objects (tables or the like) are located in between. Unfortunately, the room, furnishings or other circumstances do not always allow for optimum arrangement.

Modern software in the players offers diverse possibilities to electronically compensate for possible compromises in the placement. The following general rule applies: You can always experiment on what works best in your listening room in terms of sound and appearance based on our recommendations. Let your ears (and eyes) be the judge!

Mounting the rubber damping mats

- Affix a rubber damping mat ② to the bottom of the speakers CUB 2 FR 15 and 2 rubber damping mats to the bottom of the center speaker CUB 2 C 15.

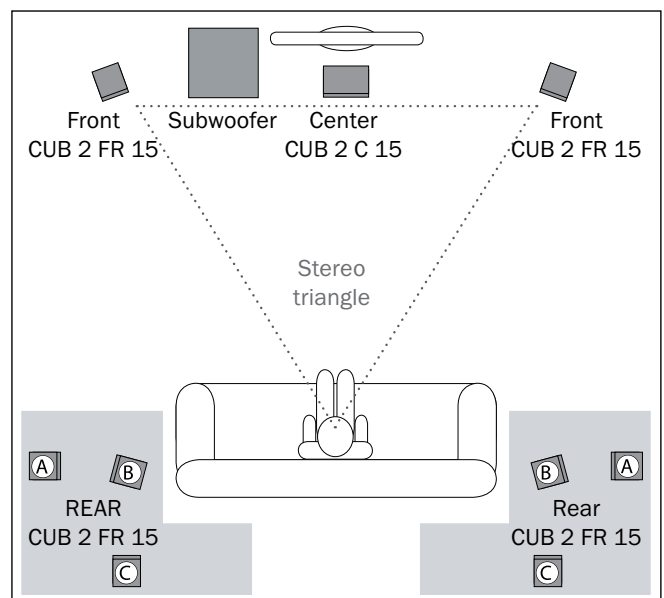

Rear speakers

- The rear speakers are set up or hung next to or behind the listener at a height of 1.20 m to 2.10 m.
- The ideal position is offset by approx. 20 degrees from the parallel position to the listener on the left and right side (A). It is generally recommended that the distance of the rear speakers to the hearer's place exceeds 1 m. However, if you (need to) sit closer please ensure that the front side of the speaker is not directly facing you. Rather, the speaker must be angled towards the wall (B). Alternatively, you can create a greater distance by placing the speakers higher than 1.20 m (e.g. also on the ceiling) or further away (C).

Centre Speaker

- Place the centre speaker in a central position under or above the video screen or screen.

Front Speaker

- The front speakers are set up to the right and left of the screen or hung at a height of approx. 80 to 160 cm.
- They should be in line with the centre speaker and form an equilateral triangle with the listener – the so-called stereo triangle (distance from the listener = distance between the speakers).
- The speakers should project sound directly into the room or slightly towards the listener.

Wall Mounting

NOTICE

Improper mounting may cause damage.

- *If mounting the speaker on the wall, make sure that it is done in a professional manner.*
- *Before drilling the holes, use a metal detector to ensure that there are no electrical cables or pipes in the wall within the drilling area.*
- *Use only suitable screws and dowels for fixing. Verify the carrying capacity of the walls.*

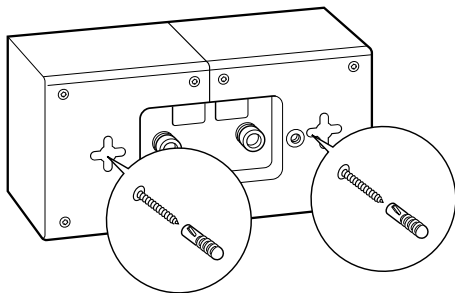

1. Hang the satellite speakers up on the wall using the keyhole openings on the speaker back side and the screws you previously mounted.

Mounting a wall holder or speaker stand

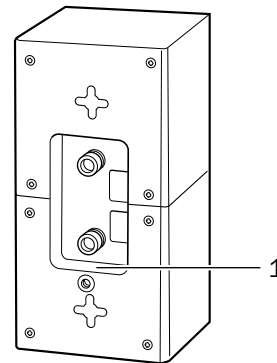

The threaded hole 1 is intended for mounting a wall holder or speaker stand. You can find suitable products for this in our web shop.

Connecting the Speakers

CAUTION

Risk of injury/damage!

- Lay the speaker cable so that it does not pose a tripping hazard.

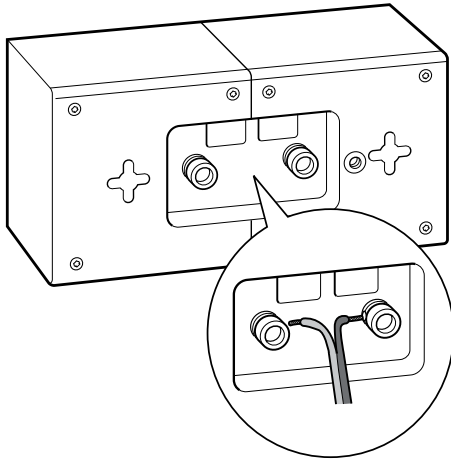

- On the back of the speakers are the connection terminals, with 2 terminal clips. You can connect the speaker cables here directly or with banana plugs or spade terminals from our catalogue. The terminals are marked in red (+) and black(-).

i Make sure the polarity is correct!

Connect the like-coloured terminals together, otherwise the sound quality will suffer. The speaker terminals of your amplifier should be similarly marked. The individual speaker cables are marked with different colours or shapes.

1. Turn off your AV receiver/multi-channel active subwoofer.
2. Lay the speaker cables from your AV receiver/multi-channel active subwoofer to each of the speakers. If your speaker cables are not long enough, order more high-quality double wire cables with marked strands on our website in the "Accessories" area.

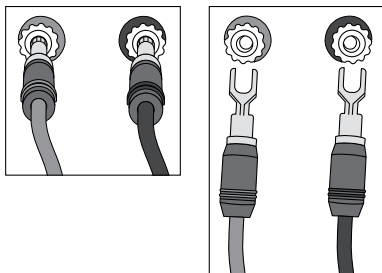

3. When you use speaker cables with banana plugs or spade terminals from our catalogue, simply insert the banana plug into the terminal with the matching colour. Spade terminals are pushed under the connector terminals and then tightened.

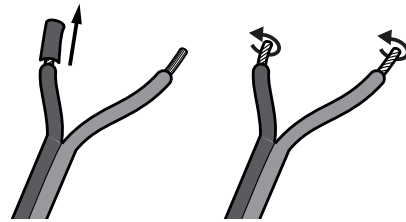

4. If you use speaker wires without plugs, split the wire down to approx. 30 mm on both ends and remove approx. 10 mm of the insulation on each end. Twist the wire so that no strands are protruding.

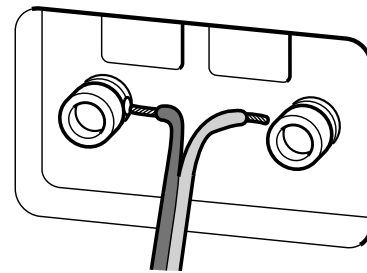

5. Turn the connector terminal counterclockwise until loose. Run the stripped cable end into the now visible hole. Close the terminal by turning it clockwise. The cable has now been clamped in place.
6. Connect the other end of the speaker cables to your AV receiver/multi-channel active subwoofer. You should be able to find corresponding notes in the operating instructions of your device.
7. Turn your AV receiver/multi-channel active subwoofer back on.

Crossover frequency

- Don't use the satellites as full-range speakers.
- It is recommended to set a separation frequency of 200 Hz on the AV receiver. Depending on the sound preferences and spatial conditions you may however also choose a value in the range from 150 to 250 Hz.
- Please be absolutely sure to adhere to the notes in the operating instructions of your AV receiver.

Care and Cleaning

NOTICE

Using the wrong cleaning solution may damage the valuable surface.

– Under no circumstances should caustic cleaning products, rubbing alcohol, thinners, gasoline, etc. be used for cleaning. Such cleaning products could damage the delicate housing surface.

- Ideally, you should remove dust or small amounts of dirt with a dry, smooth leather cloth.
- Rub off stubborn dirt with a damp cloth. If possible, only use plain water without any additives. In case of stubborn marks, a mild soap solution may be used. Make sure that no liquid penetrates the speakers.
- Then immediately wipe the surfaces dry with a soft cloth without applying pressure.

Troubleshooting

The following tips should help you to solve any problems. Should you require more help, the FAQs on our website will certainly help you. If you need further assistance, please contact us via the hotline (see page 1). Please pay attention to the warranty details.

Problem	Possible cause	Solution
Playback is noisy.	Generally speaking, the speakers are very low noise. In the high range area, very high-resolution speaker systems can expose the poor quality of a signal source (e.g. from MP3 files).	Make sure that the source is emitting a clear signal.
The sound seems dull.	Speakers have been connected with incorrect polarity.	Check to make sure the cables of all speakers are correctly connected.

Environmental Protection

Disposing of the speakers



Old devices must not be disposed of with household trash!

If the device is not longer operational, every consumer is required by law to dispose of old devices separately from household trash, e.g. at a

collection point run by the city or county authorities. This ensures that old devices are recycled in a professional manner and also rules out negative consequences for the environment.

For this reason, electrical equipment is marked with the adjacent symbol.

Technical Data

Dimensions (WxHxD)	95×188×95 mm*
Weight	1.4 kg
Impedance	4–8 Ohm
	* When measured with the speakers covers, the depth is 97 mm.

Further technical data can be found on our website. Technical changes reserved.

Lautsprecher Teufel GmbH

BIKINI Berlin
Budapester Str. 44
10787 Berlin (Germany)

www.teufelaudio.com

Phone: 00800- 200 300 40 (toll-free)

Fax: +49 (0)30 / 300 930 930

Teufel